

MASTER PLAN

**PLANNING BOARD
APPROVED**

DATE
AUGUST 8, 2018

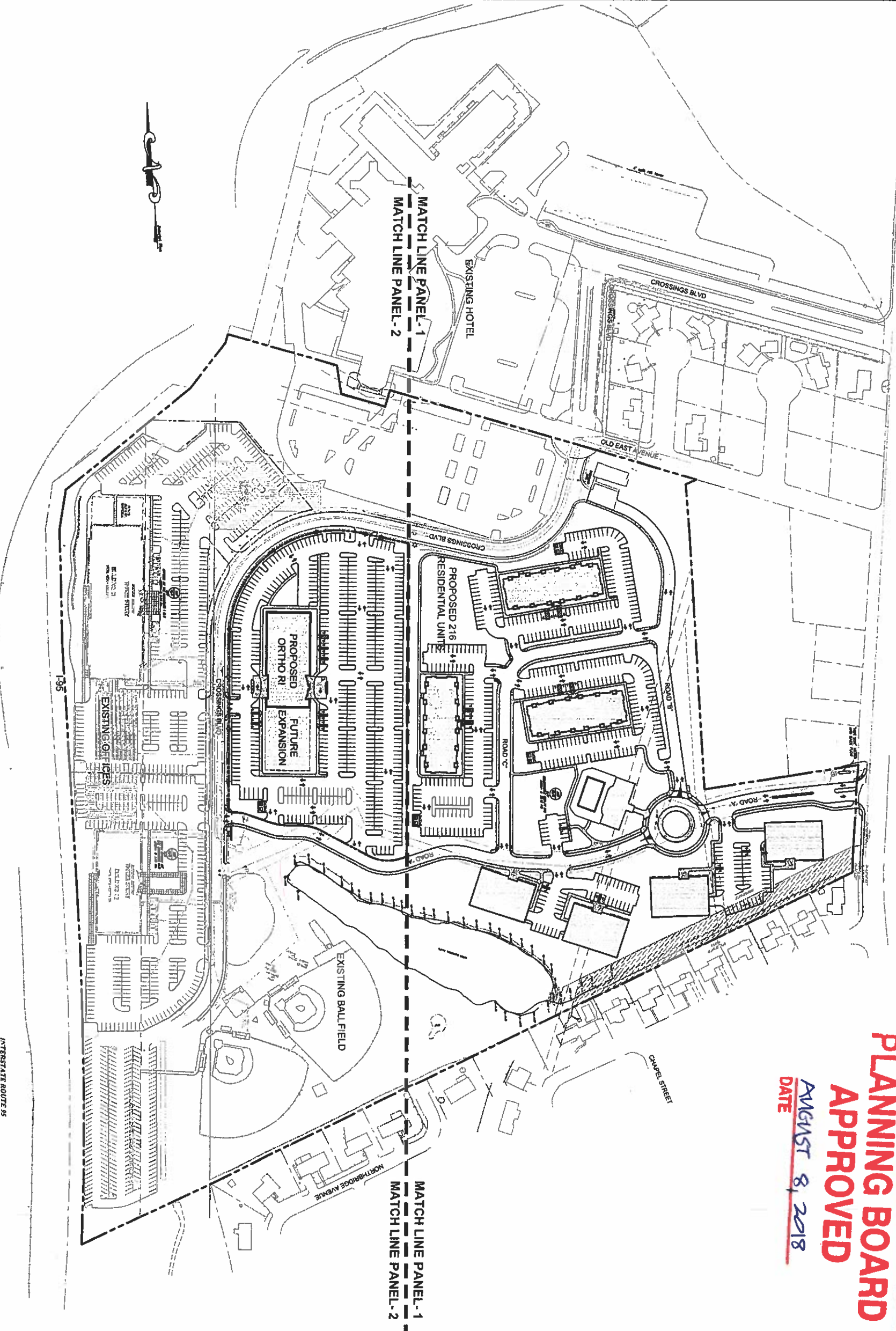

OVERALL / KEY PLAN
SCALE 1" = 100'



OWNER/APPLICANT:
A.P. 257 LOT 10
BELLECASTLE REALTY, INC.
151 AVENUE ONE
JOHNSTON, RI 02819

GAROFALO

GAROFALO & ASSOCIATES, INC.
CIVIL & STRUCTURAL ENGINEERS/SURVEYORS
LAND PLANNERS/ENVIRONMENTAL SCIENTISTS

85 CORLISS STREET
P.O. BOX 6145
PROVIDENCE, R.I. 02940
TEL. 401-273-6000



NO.	REVISION	BY	DATE
1	GENERAL LAYOUT MOD.	KYY	7/13/18

OVERALL / KEY PLAN
FOR
ORTHO RI
AT THE CROSSINGS
A.P. 257 LOT 10
SITUATED ON
GREENWICH AVENUE
WARWICK, RHODE ISLAND
PREPARED FOR
BELLECASTLE REALTY, INC.

JOB NO. 5539-05
DWG. NO. 5539-05-BASE
SCALE: AS SHOWN
DATE: MAY 30, 2018

DRAWN BY: K.Y.Y.
CHECKED: S.B.G.
APPROVED: S.B.G.
DATE: MAY 30, 2018

MP3

3 OF 7 SHEETS