

PHASE 1 PLANT SCHEDULE:

Symbol	Botanical Name	Common Name	Quantity	Size	Root	Notes	BLOOM TIME	BLOOM COLOR
Trees								
BH	Betula nigra 'Heritage River'	Heritage River Birch	4	2.3-3" cal.	B&B	Multi trunk specimen	Spring	NA
TH	Thuja plicata 'Green Giant'	Green Giant Arborvitae	33	4.5" ht	B&B	Specimen trees	Evergreen	Non Blooming
PS	Pinus strobus*	White Pine	26w/	10-12" ht	B&B	Plant 15' on center	Evergreen	Non Blooming
Shrubs								
HA	Hamamelis x intermedia 'Arnold Promise'	Witch Hazel	4	5 gallon	container	spread 15'-20'	winter	Yellow
IG	Ilex glabra	Hollyberry Holly	10	5 gallon	container	Spread 6'-8'	Evergreen	Non Blooming
JRH	Juniperus x 'Bar Harbor'	Bar Harbor Juniper	6	3 gallon	container	Spread 5'	Evergreen	Non Blooming
RR	Rosa 'RedSunny'	Knockout Rose	16	3 gallon	container	Spread 3'-4'	Spring	Yellow
Grasses and vines								
HNB	Hedera helix 'Baltica'	Baltica English Ivy	56	flats	bare root	25 plants per flat	NA	NA
MC	Miscanthus sinensis 'Gracillimus'	Maidenhair Grass	4	3 gallon	container	Spread 3'-4'	Summer	NA

* ACTUAL QUANTITIES SHALL BE DETERMINED IN FIELD IN COLLABORATION WITH LANDSCAPE ARCHITECT, CITY OFFICIALS AND OTHER

PHASE 2 PLANT SCHEDULE:

QTY.	SYMB.	BOTANICAL NAME	COMMON NAME	SIZE	ROOT BALL	NOTES
4	BNH	Betula nigra 'Heritage'	River Birch	10/12"	B&B	37" O.C.
48	CA-H	Clethra 'Hummingbird'	Summersweet	#3 gal.	Container	3'-6" O.C.
63	CA-KF	Calamagrostis x acutiflora 'Karl Foerster'	Feather Reed Grass	#2 gal.	Container	2' O.C.
80	IG-D	Ilex glabra 'Densa'	Densa Holly	#3 gal.	Container	3'-9" O.C.
32	JF-N	Juniperus procumbens 'Nana'	Garden Juniper	#2 gal.	Container	6' O.C.
97	PA-H	Pennisetum alopecuroides 'Hameln'	Dwarf Fountain Grass	#1 gal.	Container	2'-4" O.C.
31	RO-BK	Rosa 'Blushing Knockout'	Blushing Knockout Shrub Rose	#3 gal.	Container	3'-6" O.C.
107	SB-T	Spiraea betulifolia 'Tor'	Tor Birchleaf Spirea	#2 gal.	Container	2'-10" O.C.
45	TP-GG	Thuja plicata 'Green Giant'	Green Giant Arborvitae	6"	B&B	8'-6" O.C.
200	VA-TH	Vaccinium angustifolium 'Top Hat'	Top Hat Lowbush Blueberry	#1 gal.	Container	1'-6" O.C.

VEGETATION COVER CALCULATIONS:

Total Land Area: 470,520 SF
 Total of Existing & Proposed Vegetation: ±63679 SF
 Percentage of Existing & Proposed Vegetation Over Site: ±13.5%

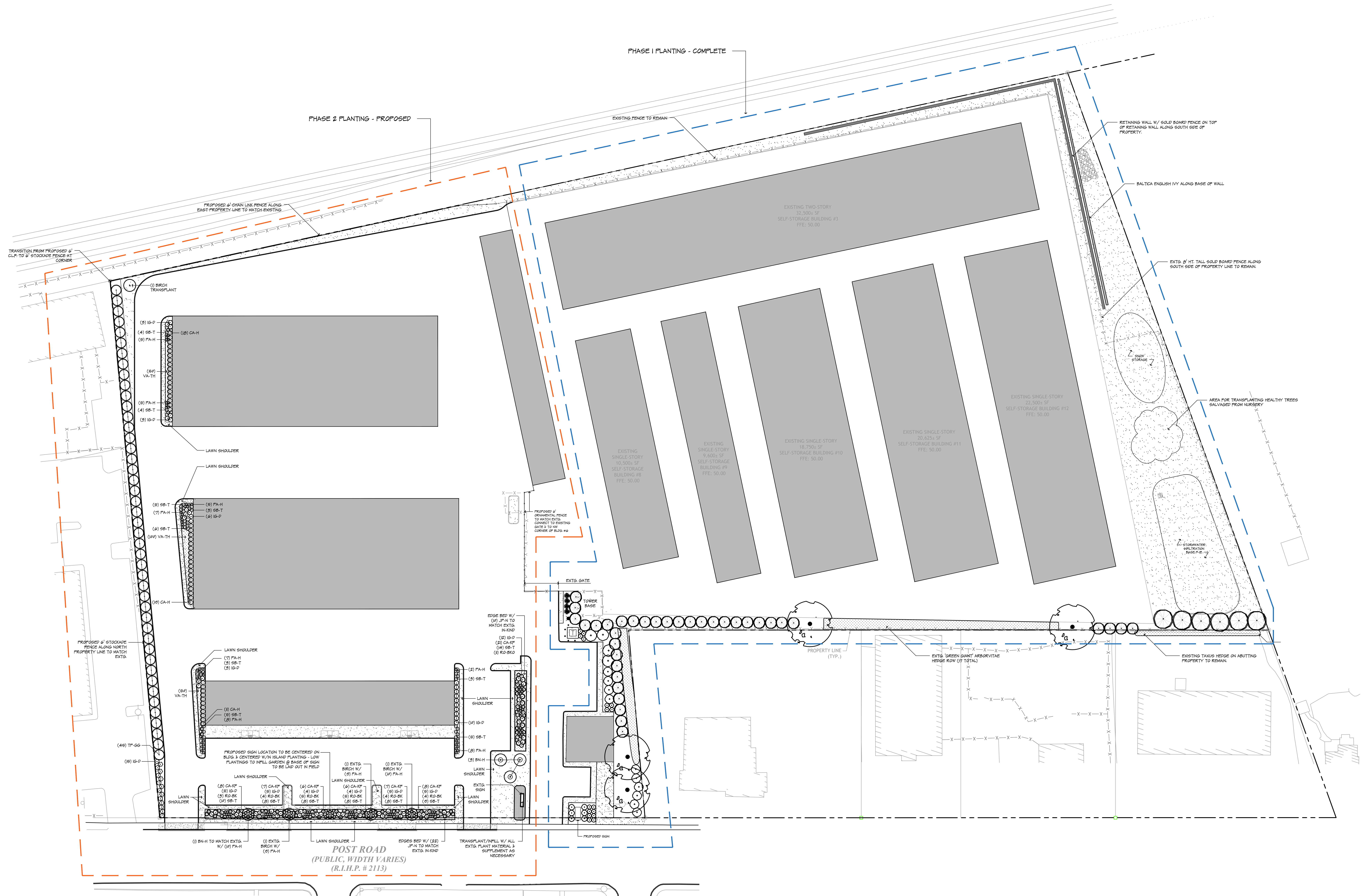

INFINITY DESIGN GROUP, INC.

 LANDSCAPE ARCHITECTURE & SITE PLANNING
 640 THAMES ST
 NEWPORT, RI 02840
 O: 401.846.1610
 C: 401.474.8644
 www.infinitydesigninc.com
 A Rhode Island Corporation

CONTRACTOR
 I have reviewed the drawings and documents and agree to the conditions and terms of the contract. I understand that the drawings and documents are the property of the landscape architect and have been prepared for the contract. I will not use the drawings and documents for any other purpose without the written consent of the landscape architect.

REVISIONS:
 10/4/23
 10/16/23
 10/17/23



MIXED USE FACILITY
 2826 POST ROAD WARWICK, RI 02886

DATE: 03/10/23

DRAWN BY: PS CHECKED BY: PS

SCALE: 1"=30'-0"

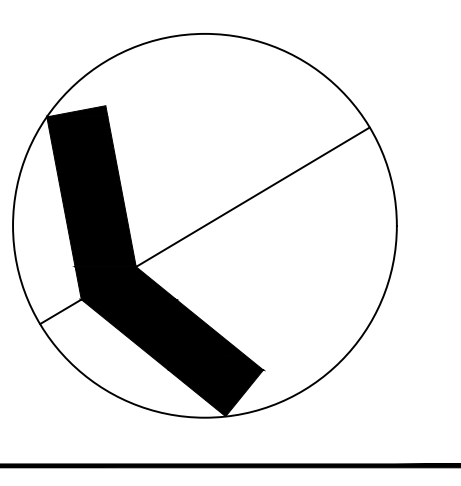

PLANTING PLAN

SHEET:

L1.0

NOTE: FOR PERMITTING ONLY - NOT FOR CONSTRUCTION