

# LANDSCAPE PLANS

## ANN & HOPE REDEVELOPMENT - PHASE II

LOCATED AT:

Post Road  
Assessor's Plat 322, Lot 209  
Warwick, Rhode Island

PREPARED FOR THE:

**CROSSROADS CAPITAL**  
95 Sockanossett Crossroads, Suite 203  
Cranston, Rhode Island 02920

### SHEET INDEX

NUMBER	TITLE	ISSUED FOR PERMITTING	REVISIONS
	COVER SHEET		
1	PLANTING PLAN	10-19-2023	2-2-2024
2	LANDSCAPE NOTES & DETAILS	10-19-2023	2-2-2024

PREPARED BY:

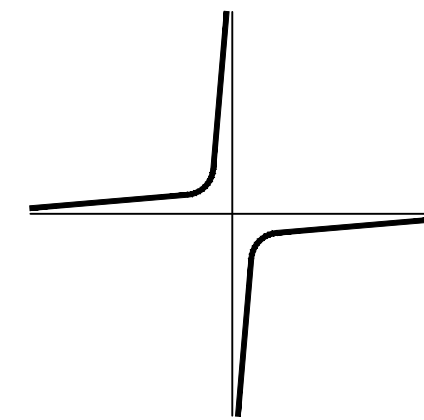

**JOHN C. CARTER & CO., INC.**

960 BOSTON NECK RD., NARRAGANSETT, RI  
(401) 783 - 3500

**LANDSCAPE ARCHITECTURE  
DESIGN & BUILD**

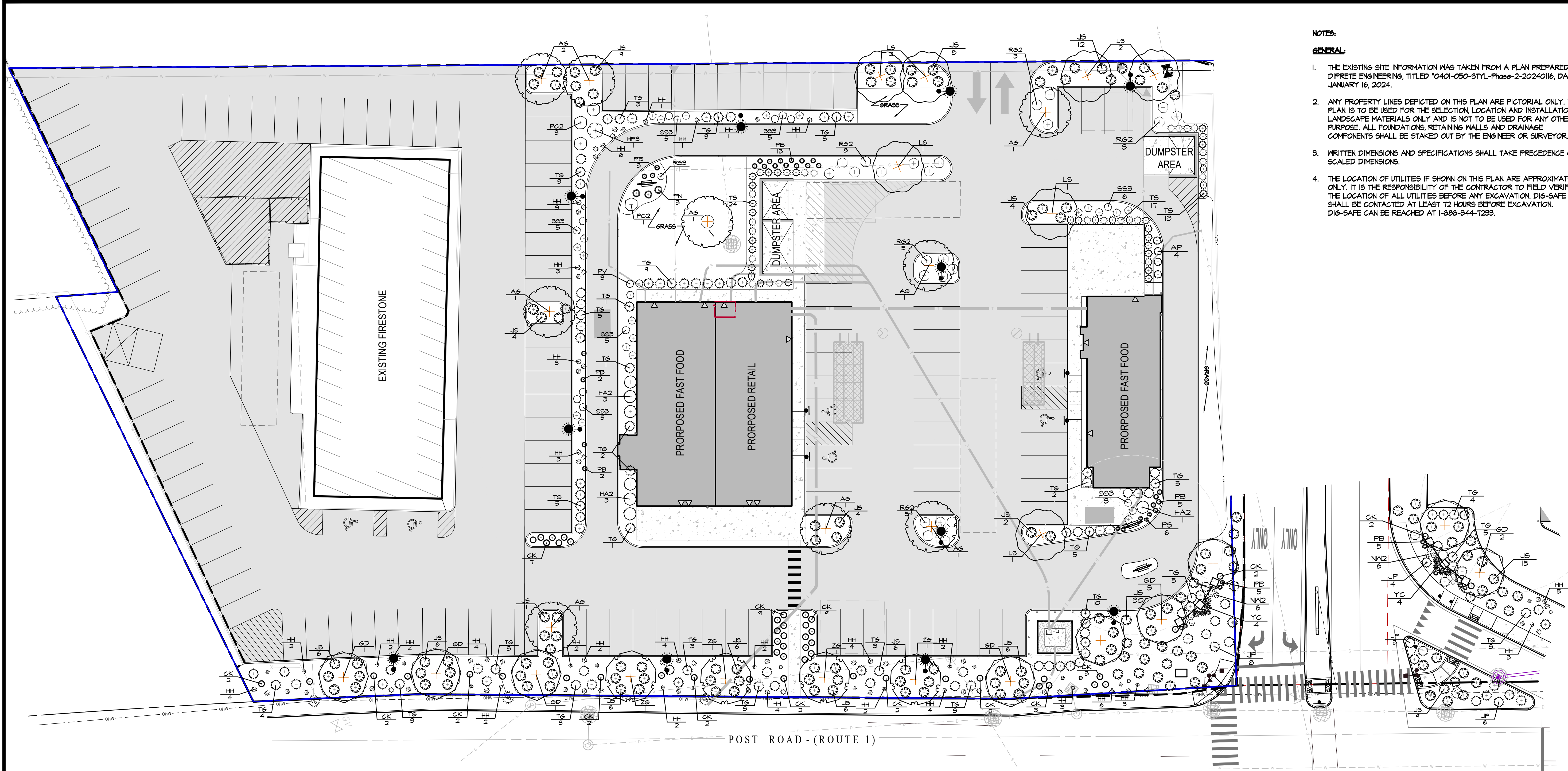

**NOTES:**

**GENERAL:**

1. THE EXISTING SITE INFORMATION WAS TAKEN FROM A PLAN PREPARED BY DIPRETE ENGINEERING, TITLED '0401-050-STYL-Phase-2-20240116, DATED JANUARY 16, 2024.
2. ANY PROPERTY LINES DEPICTED ON THIS PLAN ARE PICTORIAL ONLY. THIS PLAN IS TO BE USED FOR THE SELECTION, LOCATION AND INSTALLATION OF LANDSCAPE MATERIALS ONLY AND IS NOT TO BE USED FOR ANY OTHER PURPOSE. ALL FOUNDATIONS, RETAINING WALLS AND DRAINAGE COMPONENTS SHALL BE STAKED OUT BY THE ENGINEER OR SURVEYOR.
3. WRITTEN DIMENSIONS AND SPECIFICATIONS SHALL TAKE PRECEDENCE OVER SCALED DIMENSIONS.
4. THE LOCATION OF UTILITIES IF SHOWN ON THIS PLAN ARE APPROXIMATE ONLY. IT IS THE RESPONSIBILITY OF THE CONTRACTOR TO FIELD VERIFY THE LOCATION OF ALL UTILITIES BEFORE ANY EXCAVATION. DIG-SAFE SHALL BE CONTACTED AT LEAST 72 HOURS BEFORE EXCAVATION. DIG-SAFE CAN BE REACHED AT 1-888-344-1233.

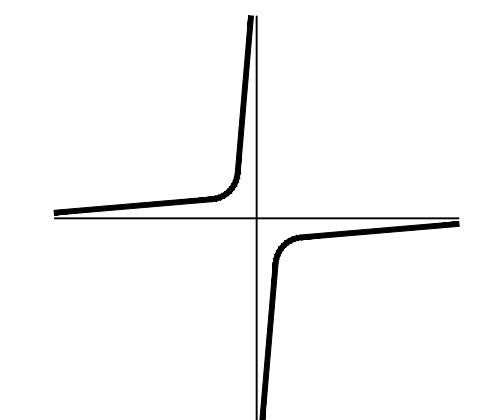

JOHN C. CARTER & CO., INC.  
LANDSCAPE ARCHITECTURE  
960 BOSTON NECK RD., NARRAGANSETT, RI  
(401) 783-3500

# PLANTING PLAN

ANN & HOPE DEVELOPMENT - PHASE II

POST ROAD  
ASSESSOR'S PLAT 322, LOT 209  
WARWICK, RHODE ISLAND

Prepared for:  
Crossroads Capital VI, LLC  
95 Sockanosset Crossroads  
Cranston, RI 02920

PLANT SCHEDULE				
TREES	QTY	BOTANICAL NAME	COMMON NAME	SIZE
A6	4	ACER RUBRUM 'OCTOBER GLORY' TM	OCTOBER GLORY MAPLE	2-1/2 TO 3" CAL.
G6	4	GLEDITSIA TRIACANTHOS INERMIS 'DRAVES'	STREET KEEPER HONEY LOCUST	2-1/2 TO 3" CAL.
L5	7	LIQUIDAMBAR STYRACIFLUA 'ROTUNDILOBA'	AMERICAN SWEET GUM	2-1/2 TO 3" CAL.
Z6	4	ZELKOVA SERRATA 'GREEN VASE'	GREEN VASE JAPANESE ZELKOVA	2-1/2 TO 3" CAL.
SHRUBS	QTY	BOTANICAL NAME	COMMON NAME	SIZE
AP	4	AZALEA X 'PLEASANT WHITE'	GIRARD PLEASANT WHITE AZALEA	15-18" HT
HA2	7	HYDRANGEA MACROPHYLLA 'BLOOMSTRUCK'	BLOOMSTRUCK HYDRANGEA	18-24" HT
HF3	1	HYDRANGEA PANICULATA 'PINKY NINKY'	PANICLED HYDRANGEA	24-30" HT.
JS	150	JUNIPERUS CHINENSIS 'SARGENTII'	SARGENT JUNIPER	5 GAL
JP	21	JUNIPERUS PROCUMBENS 'NANA'	DWARF JAPANESE GARDEN JUNIPER	5 GAL
PC2	4	PHYSOCARPUS OPULIFOLIUS 'CENTER GLOW'	CENTER GLOW NINEBARK	18-24" HT
R62	24	RHUS AROMATICA 'GRO-LOW'	GRO-LOW FRAGRANT SUMAC	15-18" HT
SS3	34	SPIRAEA JAPONICA 'SHIROBANA'	SHIROBANA SPIREA	15-18" HT
T6	100	TAXUS X MEDIA 'GREENWAVE'	GREENWAVE SPREADING YEM	18-24" HT
TS	54	THUJA OCCIDENTALIS 'SMARAGD'	EMERALD GREEN ARBORVITAE	4-5' HT
GRASSES	QTY	BOTANICAL NAME	COMMON NAME	SIZE
CK	51	CALAMAGROSTIS X ACUTIFLORA 'KARL FOERSTER'	FEATHER REED GRASS	2 GAL
FV	3	PANICUM VIRGATUM	SWITCH GRASS	2 GAL
FN	3	PANICUM VIRGATUM 'NORTH WIND'	NORTHWIND SWITCH GRASS	2 GAL
PS	6	PANICUM VIRGATUM 'SHENENDOAH'	BURGUNDY SWITCH GRASS	2 GAL
PB	35	PENNISSETUM ALOPECUROIDES 'LITTLE BUNNY'	LITTLE BUNNY FOUNTAIN GRASS	2 GAL
ANNUALS/PERENNIALS	QTY	BOTANICAL NAME	COMMON NAME	SIZE
HH	40	HEMEROCALLIS X 'HAPPY RETURNS'	HAPPY RETURNS DAYLILY	2 GAL
NM2	12	NEPETA X FAASSENII 'WALKERS LOW'	WALKERS LOW CATMINT	2 GAL
YC	8	YUCCA FILAMENTOSA 'COLOR GUARD'	COLOR GUARD ADAM'S NEEDLE	3 GAL
ROSES	QTY	BOTANICAL NAME	COMMON NAME	SIZE
RS3	1	ROSA DRIFT 'GROUNDCOVER SWEET'	SWEET DRIFT ROSE	5 GAL

**NOTE:**

THE PROPOSED PLANTINGS ON THIS PLAN AT THE ENTRANCE AND ALONG POST ROAD WERE INCLUDED IN THE LANDSCAPE PLANS APPROVED BY THE CITY. THE ENTRANCE FEATURE (COLUMNS AND FENCINGS) HAVE BEEN RECONFIGURED TO ACCOMMODATE PHASE II DESIGN.

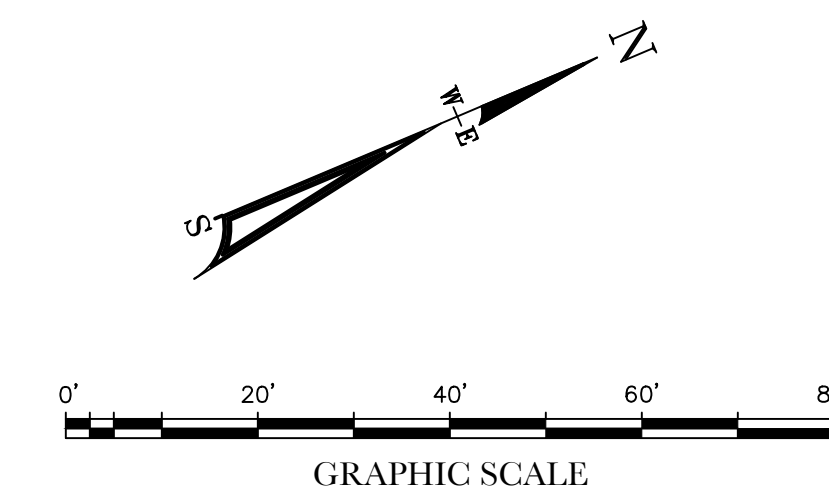

REVISIONS  
2-2-24 Entrance walls, plantings per layout changes, general notes.

SCALE 1"=20'  
DATE October 19, 2023

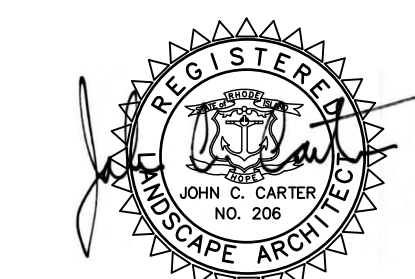

SHEET NUMBER

1

