

TYPICAL POLE BASE DETAIL (PARKING AREAS)
NOT TO SCALE

- TYPICAL POLE BASE NOTES:**
- PROVIDE POLES AS SPECIFIED IN SCHEDULE ON DRAWINGS. PROVIDE POLE WITH HANDHOLE AND REMOVABLE WEATHERPROOF COVER.
 - PROVIDE ANCHOR BOLTS: AS RECOMMENDED BY POLE MANUFACTURER, PROVIDE TEMPLATE, FLAT WASHERS, LOCK WASHERS, AND HEX NUTS FOR EACH POLE.
 - PROVIDE FOUNDATIONS FOR POLES, BOLLARDS, AND GROUND-MOUNTED FLOOD AND ACCENT LIGHTING. CONSTRUCTED FROM REINFORCED CONCRETE IN SIZES AS SHOWN ON DRAWINGS AND TO MEET THE MINIMUM STRUCTURAL REQUIREMENTS OF IBC 1807.3 EMBEDDED POSTS AND POLES. PLACE THE ANCHOR BOLTS IN POLE BASES SO THAT THE LUMINAIRE WILL BE ORIENTED PERPENDICULAR TO THE CURB/STREET/SIDEWALK/PARKING LOT OR AS INDICATED ON THE PLANS. ALSO, REFER TO MANUFACTURERS' PHOTOMETRICS PLAN FOR CORRECT ORIENTATION OF LUMINAIRE PRIOR TO ANY WORK.
 - PROVIDE A CONCRETE-ENCASED ELECTRODE (UFER) GROUNDING SYSTEM FOR GROUNDING THE FOUNDATION, LUMINAIRE, AND POLE.
 - PROVIDE TWENTY-FIVE (25) FEET OF #6 BARE STRANDED COPPER GROUNDING ELECTRODE CONDUCTOR.
 - EXTEND THREE (3) FEET OF THE GROUNDING ELECTRODE CONDUCTOR OUT THE TOP OF THE FOUNDATION FOR CONNECTION TO THE LUMINAIRE.
 - CLAMP THE GROUNDING ELECTRODE CONDUCTOR TO THE TOP OF THE REBAR CAGE. USE A CLAMP RATED FOR SUCH USE SUCH AS AN ERICD ER16 OR SIMILAR.
 - SPIRAL A MINIMUM OF TEN (10) FEET OF THE GROUNDING ELECTRODE CONDUCTOR AROUND THE OUTSIDE OF THE REBAR CAGE.
 - LOOP THE REMAINING CONDUCTOR AROUND THE REBAR CAGE AT THE BOTTOM OF THE FOUNDATION IN DIRECT CONTACT WITH EARTH.
 - THE EXPOSED SURFACE AREA OF THE FOUNDATION SHALL HAVE THE FORMS REMOVED AND THE CONCRETE RUBBED OUT TO A SMOOTH FINISH. PAINT ALL EXPOSED SURFACE AREA PER THE ARCHITECTS AND OWNERS' DIRECTION.
 - INSTALL IN ACCORDANCE WITH MANUFACTURERS' INSTRUCTIONS.
 - UNDERGROUND AND EXTERIOR WIRE SHALL BE TYPE XHHW-2.
 - INSTALL ALL ANCHOR BOLTS AND HANDHOLE FASTENERS WITH ANTI-SEIZE COMPOUND.
 - BOND EACH LUMINAIRE, EACH METAL ACCESSORY, THE GROUND ROD AND THE POLE TO THE BRANCH CIRCUIT EQUIPMENT GROUND CONDUCTOR WITH A SEPARATE GROUND WIRE SIZED PER NEC OR AS SHOWN ON THE DRAWINGS.

LIGHTING FIXTURE SCHEDULE									
TYPE	MANUFACTURER	CATALOG No.	MOUNTING	LAMPING			VOLTAGE	DESCRIPTION / REMARKS	
				TYPE	WATTAGE	QTY.			
S1	LSI INDUSTRIES, INC.	MRM-LED-18L-SIL-SW-40-UNV-70CR(CBA)	POLE	LED	135	-	120	SINGLE-HEAD POLE MOUNTED LIGHTING FIXTURE WITH MANUFACTURER'S ROUND STEEL POLE ON CONCRETE BASE. (POLE SHALL BE 12'-0" IN HEIGHT AND ON A 3'-0" AFG CONCRETE BASE)	
S1A	LSI INDUSTRIES, INC.	SAME AS "S1", EXCEPT PROVIDE INTEGRAL LOUVER FIELD INSTALLED TO CONTROL BACKLIGHT. LSI INDUSTRIES, INC. PART NUMBER 600981.	POLE	LED	135	-	120	LOUVERED SINGLE-HEAD POLE MOUNTED LIGHTING FIXTURE WITH MANUFACTURER'S ROUND STEEL POLE ON CONCRETE BASE. (POLE SHALL BE 12'-0" IN HEIGHT AND ON A 3'-0" AFG CONCRETE BASE)	
S2	LSI INDUSTRIES, INC.	(Two) MRM-LED-18L-SIL-SW-40-UNV-70CR(CBA)	POLE	LED	(Two) 135	-	120	DOUBLE-HEAD POLE MOUNTED LIGHTING FIXTURE WITH MANUFACTURER'S ROUND STEEL POLE ON CONCRETE BASE. (POLE SHALL BE 12'-0" IN HEIGHT AND ON A 3'-0" AFG CONCRETE BASE)	

NOTES:

- ALL LIGHT FIXTURES SHALL BE PROVIDED WITH LED LAMPS INSTALLED READY FOR OPERATION. ALL LED LAMPS SHALL HAVE THE SAME COLOR TEMPERATURE FROM A SINGLE LAMP MANUFACTURER.
- ELECTRICAL CONTRACTOR SHALL ALLOW TIME FOR DIRECTIONAL AND ORIENTATION ADJUSTMENT OF ALL LIGHT FIXTURES AS DIRECTED BY ARCHITECT, ENGINEER AND/OR OWNER'S REPRESENTATIVE.
- ELECTRICAL CONTRACTOR SHALL COORDINATE WITH THE LIGHTING FIXTURE MANUFACTURER AND LIGHTING CONTROLS MANUFACTURER TO PROVIDE COMPATIBLE COMPONENTS BETWEEN LIGHTING FIXTURES AND ASSOCIATED CONTROLS. (TYPICAL)
- THE ELECTRICAL CONTRACTOR SHALL PROVIDE FOR ALL SITE POLE MOUNTED LED LIGHTING FIXTURES A THERMALLY PROTECTED SURGE PROTECTIVE DEVICE AND CONNECTED PER THE MANUFACTURER'S INSTALLATION INSTRUCTIONS. THE THERMALLY PROTECTED SURGE PROTECTIVE DEVICE SHALL BE EQUAL TO LITLIFUSE #LSP10. (TYPICAL)

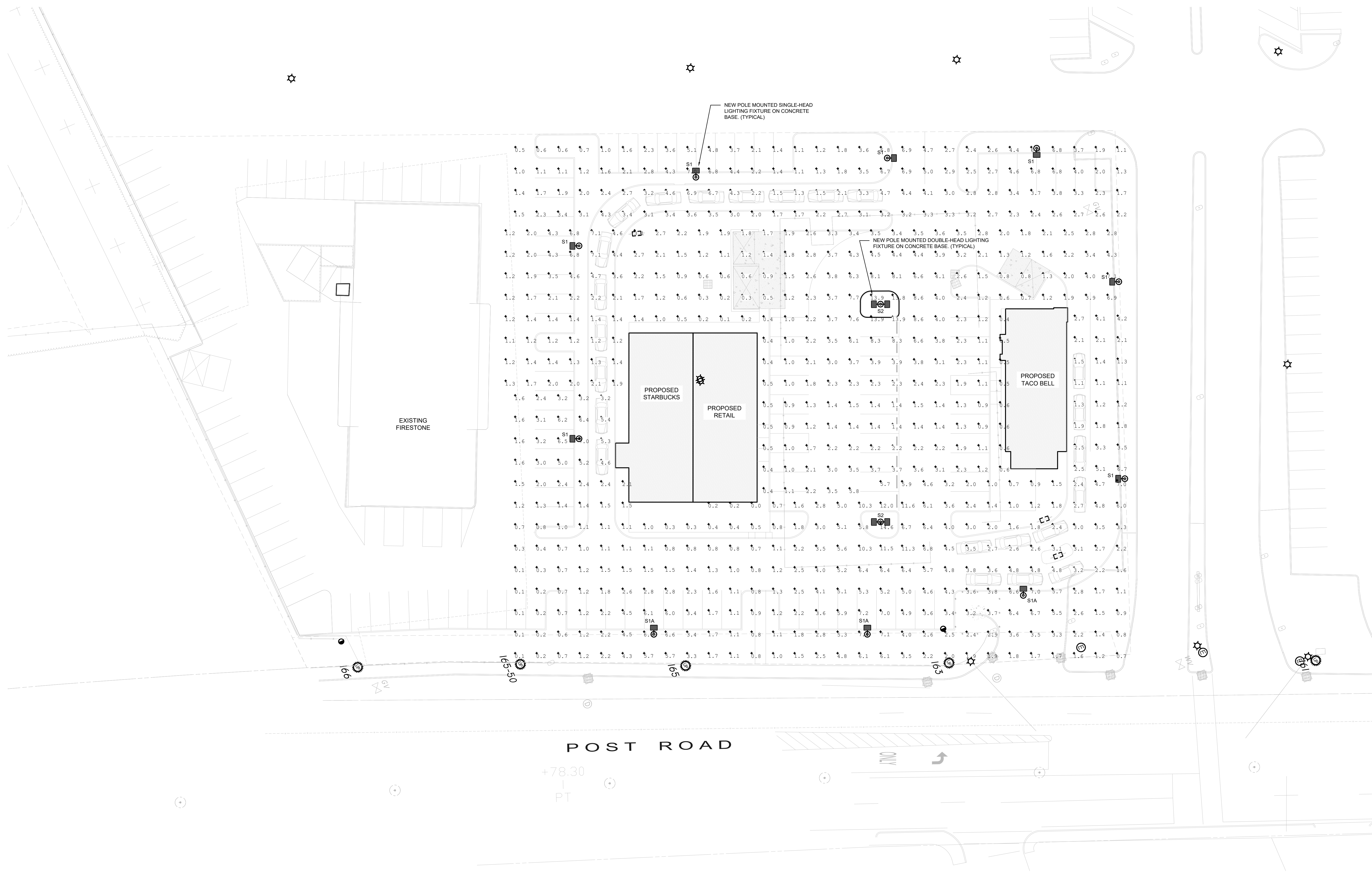

1 ELECTRICAL: SITE LIGHTING PHOTOMETRICS PLAN
ES101 SCALE: 1/64"=1'-0"

CERTIFICATION: RAYMOND W. DUSSEAU III
No. 7139
REGISTERED PROFESSIONAL ENGINEER (ELECTRICAL)

THIS DRAWING IS A PART OF AN INTEGRATED SET OF CONSTRUCTION CONTRACT DOCUMENTS. REFER TO ALL DRAWINGS AND SPECIFICATIONS INCLUDING BUT NOT LIMITED TO "GENERAL CONDITIONS" SUMMARY OF WORK, AND ANY APPLICABLE MANUFACTURERS TECHNICAL SPECIFICATIONS.

REFER TO ALL DRAWINGS FOR COMPLETE SCOPE OF WORK.

THIS DRAWING IS NOT TO BE SCALED OR USED AS AN AS-BUILT.

REV. NO.	DATE	DESCRIPTION
	11/30/23	FOR PERMIT
	02/16/24	SITE LIGHTING REVISIONS

PROJECT NAME:
Ann & Hope Redevelopment
1689 Post Road
Warwick, RI

ENGINEERING DESIGN SERVICES INCORPORATED
141 Industrial Highway Slatersville, RI 02876
Tel (401) 765-7659 Fax (401) 765-2984

SHEET TITLE:
ELECTRICAL: SITE LIGHTING PHOTOMETRICS PLAN

JOB NO.: 23274RT
DRAWN BY: SPC
CHECKED BY: RWD
DATE ISSUED: 11/30/2023
SCALE: AS NOTED

SHEET NO.:
ES101