

Neon Marketplace | 1149 Division Street, Warwick, RI 02818 | Design Development | November 03, 2021

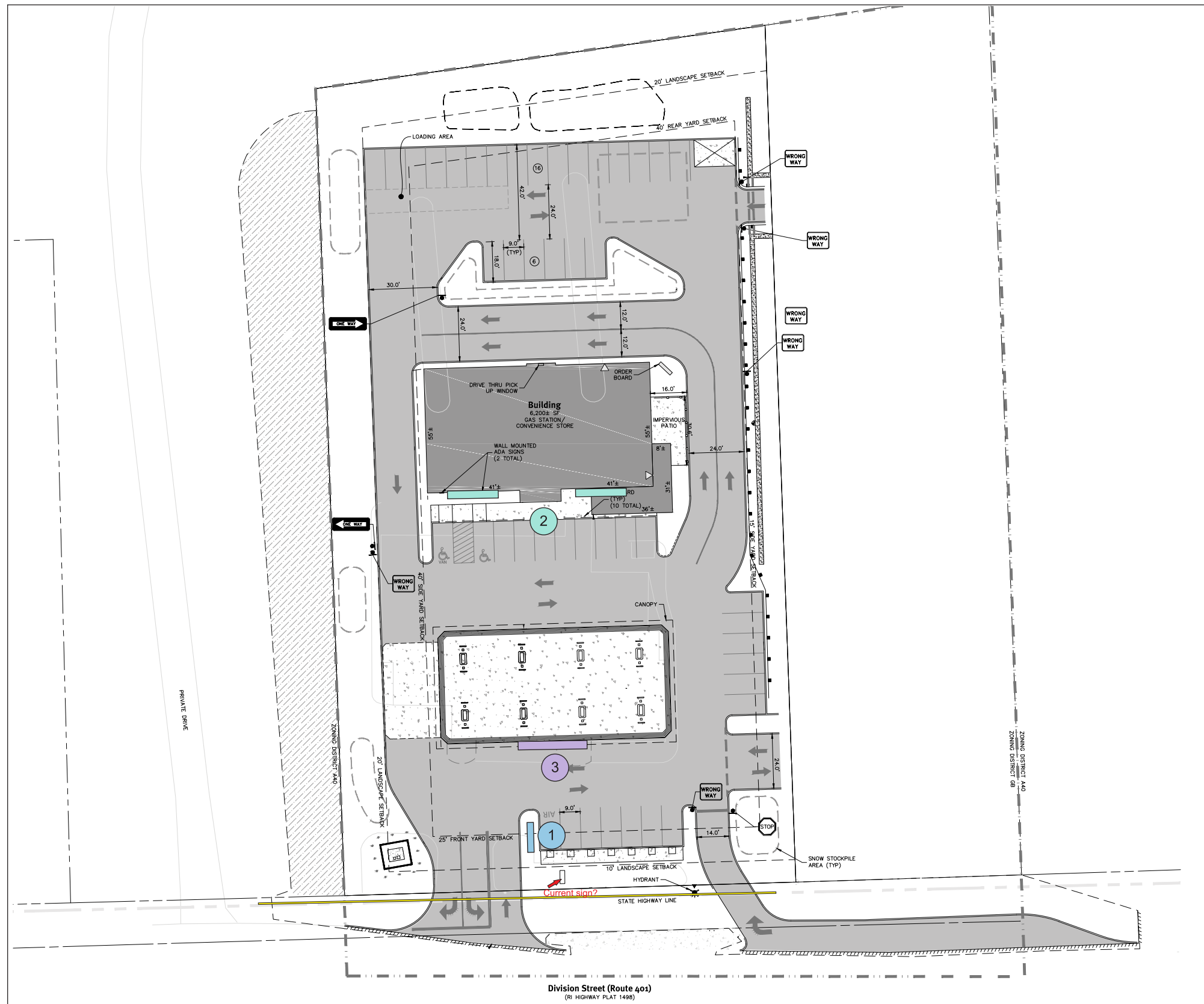



A Site Plan - Plan View
Not to Scale

Sign Type Key

- 1 Pylon Sign - Page 1A
- 2 Building Sign - Page 2A
- 3 Canopy Sign - Page 3A



A Poyant Company

125 Samuel Barnet Boulevard
New Bedford, MA 02745
800.544.0961 | poyantsigns.com



1149 Division Street
Warwick, RI 02818

Project: 20347
Neon Marketplace

Sales: Jeff Carter
Date: 11.03.21
Designer: NLM

Note:
This is an original unpublished drawing created by Poyant Signs, Inc. It is submitted for your personal use in connection with a project being planned for you by Poyant Signs, Inc. It is not to be shown to anyone outside your organization, nor is it to be reproduced, copied or exhibited in any fashion until transferred.

Revisions:



This sign is intended to be installed in accordance with the requirements of Article 600 of the National Electrical Code and / or other applicable local codes. This includes proper grounding and bonding of the sign.

Approved By:

Date:

Site Plan

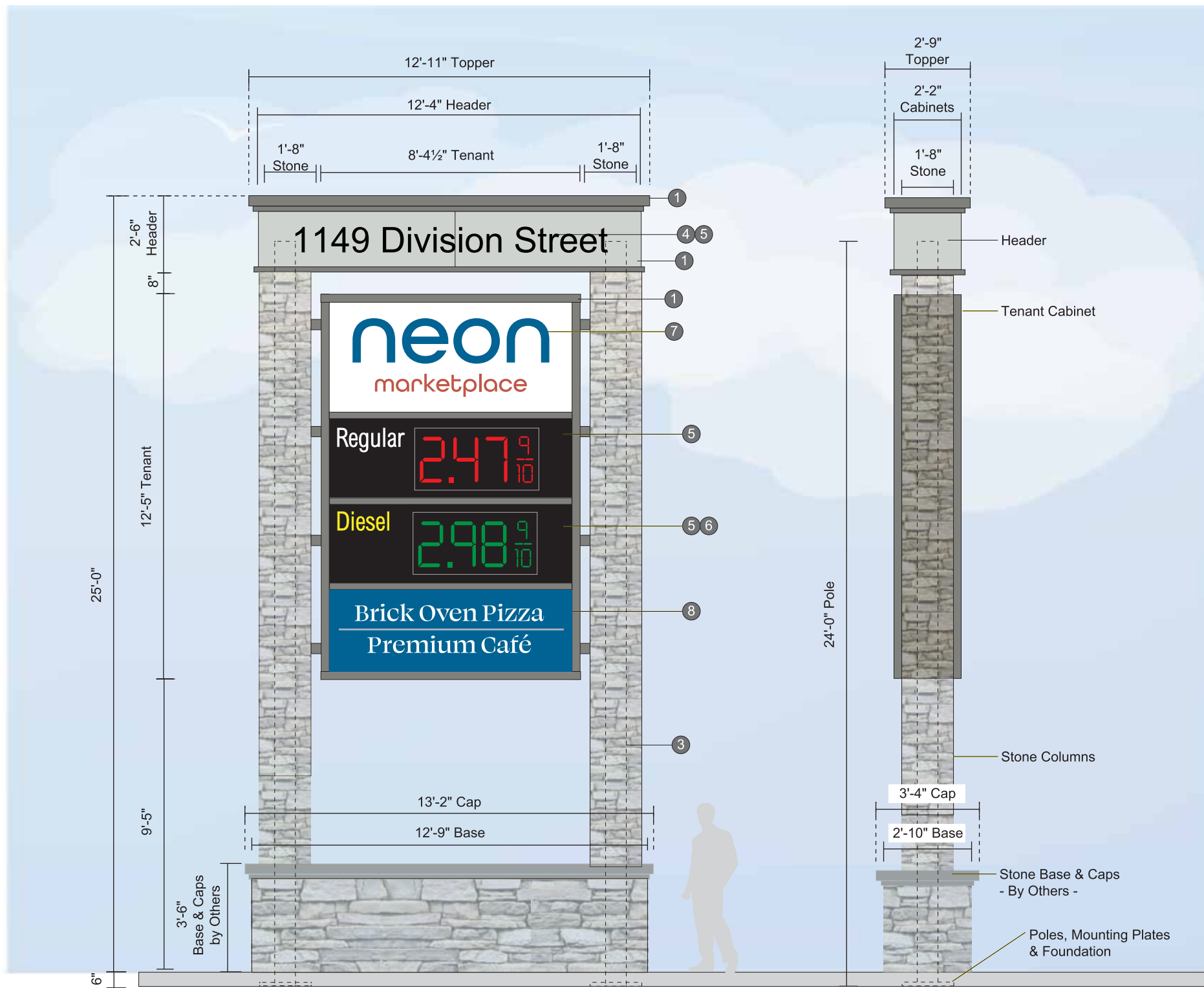

A Sign Elevation - Front View
Scale: 1/4"=1'-0"

B Sign Elevation - Side View
Scale: 1/4"=1'-0"

Specifications

Qty = 1

103.9 Sq Ft

Double Faced Internally Illuminated Pylon Sign

Header

- Internally Illuminated Frame with aluminum bleedfaces
- Push thru graphics
- 4" x 4" x 1/8" Alum tube & 2" x 2" x 1/8" Alum tube decorative elements

Tenant Cabinet

- Internally Illuminated Type 1 Wide Fab Cabinet with lexan faces
- Electronic Gas price changers
- Grounding Rods
- Secured to poles using 4" x 4" x 3/16" Steel Tubes Running Horizontally

Stone Columns

- Fabricated angle frame with 1/2" thick cement board
- Stone provided & installed by others - after install

Poles & Foundation

- (Qty:2) 8" x 8" x 3/8" x 24'-0"H Steel Poles with mounting plates
- (Qty:1) Per Pole 20" x 20" x 1 1/2" Thick Steel Mounting Plate
- Poles to be plate mounted using (Qty:4) 1 1/4"Dia Anchor Bolts @ 20"Min Embedment
- (Qty:1) 4'-0"D x 14'-0"W x 8'-0"WL Direct burial foundation - By Others
- Foundation to have #4 rebar @ 12"OC top & bottom
- Rebar Cage & Fully Assembled Anchor Bolts by Poyant
- Mounting plates to be concealed 6" below grade & backfilled with soil

Electrical

- 120V Primary Electrical to be fed thru foundation, thru conduit
- Electrical to be fed thru mounting plate, thru pole & into sign cabinet

Stone Base & Caps - By Others

- Provided & Installed by Others after sign is installed
- No Frame to be provided by Poyant

Provided By Others

- (Qty:1) 4'-0"D x 14'-0"W x 8'-0"WL Direct burial foundation
- 2" Thick Stone Veneer & Stone Base - Provided & Installed by others
- Primary Electrical - Min of (Qty:2) 20 amp, 120 circuits to be provided in conduit
- EMC's require their own dedicated circuit
- Customers electrician to provide best pathway to termination for grounding rod

- See Page SP for Site Plan

Colors & Materials

- 1 Paint Dark Gray; Satin Finish - Match BM CW-720 Geddy Gray
- 2 Paint Light Gray; Satin Finish - Akzo Nobel 495-D2
- 3 2" Thick Stone Veneer **By Others**
- 4 Translucent Vinyl - Push Thrus Only White 3M 3630-20
- 5 Translucent Vinyl - Push Thrus Only & EMC Faces Black 3M 3630-20
- 6 Translucent Vinyl - "Diesel" Golden Yellow 3M 3630-125
- 7 Digital Print (Qty:2) 30 1/2" x 76" Digitally Printed Translucent Vinyl - UV Laminate & Kiss Cut around Graphics - White to be weeded out & removed - Match Blue PMS 3015C & Match Red C23 M71 Y94 K41
- 8 Digital Print (Qty:2) 33" x 97" Digitally Printed Translucent Vinyl - UV Laminate & Kiss Cut around Graphics - White to be weeded out & removed - Match Embedded CMYK Colors



1149 Division Street
Warwick, RI 02818

Project: 20347
Neon Marketplace

Sales: Jeff Carter
Date: 11.03.21
Designer: NLM

Note:

This is an original unpublished drawing created by Poyant Signs, Inc. It is submitted for your personal use in connection with a project being planned for you by Poyant Signs, Inc. It is not to be shown to anyone outside your organization, nor is it to be reproduced, copied or exhibited in any fashion until transferred.

Revisions:

11.03.21 NLM Same as Seekonk 19923-1C



This sign is intended to be installed in accordance with the requirements of Article 600 of the National Electrical Code and / or other applicable local codes. This includes proper grounding and bonding of the sign.

Approved By:

Date:

Pylon Sign

Option A