

**THOMAS LONARDO & ASSOCIATES**  
A CORPORATION

- ARCHITECTURE •
- INTERIOR DESIGN •
- MANAGEMENT •

80 ATWOOD AVENUE  
CRANSTON, RHODE ISLAND  
(401) 944-2600 02920

PROJECT  
**WARWICK SCHOOLS RE-ROOFING PROJECTS**  
ALDRICH MIDDLE SCHOOL  
789 POST ROAD  
WARWICK, RHODE ISLAND

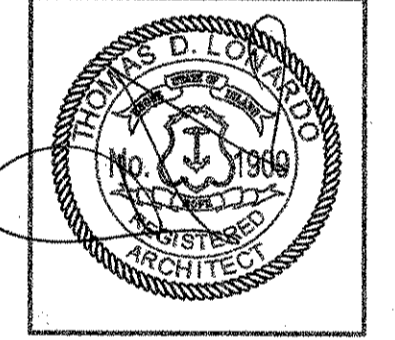

REVISIONS	DATE	BY:

THESE DRAWINGS ARE THE SOLE PROPERTY OF THE ARCHITECT. NO PORTION OF THIS DRAWING MAY BE REPRODUCED WITHOUT THE WRITTEN CONSENT OF THE ARCHITECT. THE PROJECT FOR WHICH THESE DRAWINGS HAVE BEEN PREPARED AND ARE NOT TO BE DUPLICATED OR COPIED IN ANY WAY. VIOLATION OF THIS COPYRIGHT AGREEMENT MAY LEAD TO LEGAL ACTION AGAINST THE VIOLATORS.

DRAWING  
**ROOF PLAN & NOTES**  
SCALE: 1/16" = 1'-0"  
DRAWN: BASH  
CHKD. TDL  
P.I.C. TDL  
DATE: JULY 19, 2000  
PROJECT # 0003  
SHEET NO. 3 OF 6

**A1.3**

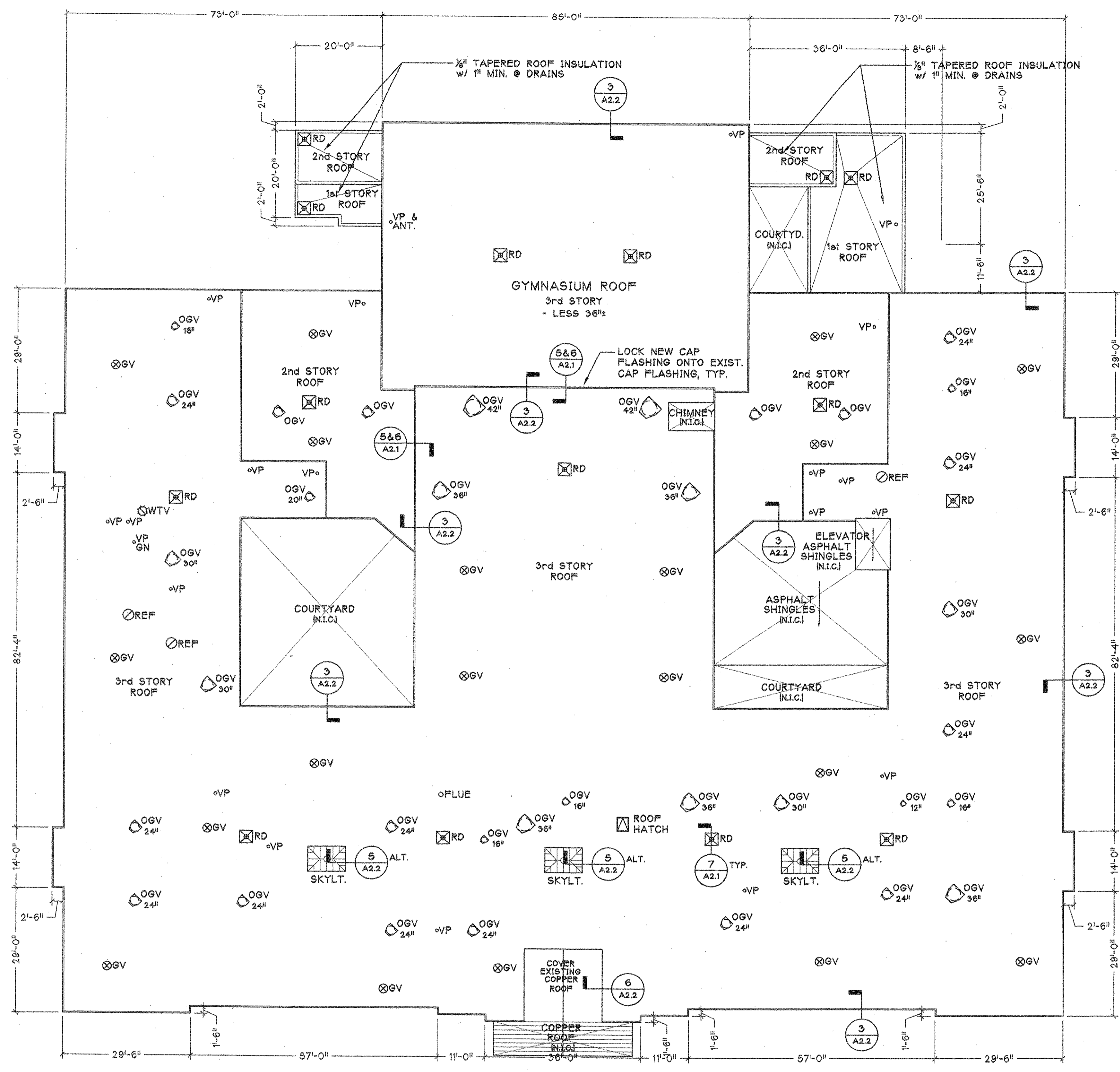

**1 ROOF PLAN**  
A1.3 SCALE: 1/16" = 1'-0"  
ALDRICH MIDDLE SCHOOL  
40,000 +/- SQ. FT.

- ABBREVIATIONS:**
- ANT. ANTENNA
  - CONC. CONCRETE
  - GV GRAVITY VENT
  - OGV OSCILLATING GRAVITY VENT
  - N.I.C. NOT IN CONTRACT
  - P.T. PRESSURE TREATED
  - RD ROOF DRAIN
  - REF ROOF EXHAUST FAN
  - SKYLT. SKYLIGHT
  - VP VENT PIPE
  - WTV WIND TURBINE VENT

**GENERAL NOTES:**

- SCRAPE & REMOVE EXISTING GRAVEL FROM ROOF; ROOF FELTS, EDGE METAL, EDGE BLOCKING AND INSULATION TO REMAIN. EXISTING ROOF SYSTEM IS TAR & GRAVEL BUILT-UP ROOFING ON INSULATION OVER CONCRETE SLABS & WOOD DECK AT THE GYMNASIUM ROOF.
- USE APPROVED INDEPENDENT INSPECTOR TO VERIFY THE INTEGRITY OF EXISTING ROOF SYSTEM PRIOR TO RE-ROOFING. PATCH AND REPAIR DAMAGED EDGE METAL, EDGE BLOCKING AND INSULATION, WHERE REQUIRED WITH SIMILAR MATERIALS. REVIEW AREAS OF DAMAGE WITH ARCHITECT PRIOR TO PROCEEDING WITH REPAIRS. COST OF REQUIRED REPAIRS TO BE PROCESSED AS CHANGE ORDERS BASED ON UNIT PRICES.
- INSTALL NEW DOUBLE P.T. WOOD BLOCKING AS DETAILED AT PERIMETER OF ROOF, INSULATION, MEMBRANE, EDGE METAL & FLASHING AS SPECIFIED. TIE NEW ROOF DRAINS TO EXISTING LEADERS OR DRAIN LINES AS DETAILED. COMPLETE INSTALLATION OF ALL RELATED FLASHING, LIFT AND RESET MECHANICAL EQUIPMENT AS REQUIRED TO INSTALL FLASHING AND TO MAINTAIN A MIN. 8 INCHES VERTICAL DIMENSION BETWEEN ROOF SURFACE AND TOP OF BASE FLASHING.

- ALL EXPOSED EDGE METAL, COPINGS & FLASHING TO BE FACTORY FABRICATED, FASTENED IN ACCORDANCE W/ SMACNA & MANUFACTURER'S RECOMMENDATIONS. FIELD FABRICATED EDGE METAL & COPINGS WILL NOT BE ACCEPTED. ALL EXPOSED EDGE METAL, COPINGS AND FLASHING TO HAVE KYNAR 500 FINISH. COLOR TO BE SELECTED.
- INSTALL COMPLETE SYSTEM AS REQUIRED TO PROVIDE ROOFING MANUFACTURER'S 15 YEAR WARRANTY. SYSTEM TO INCLUDE 60 MIL. NON-REINFORCED E.D.P.M. MEMBRANE, FULLY ADHERED TO 2" ISO INSULATION WITH MIN. DENSITY OF 25 PSI. ANCHORED WITH MIN. PULLOUT\* OF 800 PSI TO CONCRETE DECK WITH 14-10 FASTENERS AND 3/8" PILOT HOLE & 1 1/2" MIN. PENETRATION. \* 360 PSI Ø WOOD DECK WITH HP FASTENERS.
- RESURFACING OF ROOF TO INCLUDE THE ENTIRE ORIGINAL BUILDING.
- REFER TO TYPICAL DETAILS ON SHEETS A2.1 & A2.2 FOR DETAILING OF ROOF PENETRATIONS (I.E., PENETRATION POCKETS, ROOF VENTS, PLUMBING VENTS, CURBS, ETC.)
- ALL DRAINS ARE TO BE AUGURED OUT AFTER ROOF STRIPPING AND/OR ABATEMENT IS COMPLETE, AND ARE TO BE WATER TESTED TO INSURE DRAINAGE AFTER ROOF INSTALLATION.

**GENERAL REMOVAL NOTES:**

- IT IS THE RESPONSIBILITY OF THE CONTRACTOR TO VERIFY ALL EXISTING CONDITIONS AND DIMENSIONS AS THEY RELATE TO THE RE-ROOFING (ALL DIMENSIONS GIVEN, ARE APPROXIMATE). REPORT ALL OBSERVATIONS AND ANY DISCREPANCIES TO THE ARCHITECT PRIOR TO PROCEEDING WITH THE WORK.
- NO AREA OF REMOVAL IS TO BE LEFT OPEN OVER NIGHT OR DURING ADVERSE WEATHER CONDITIONS. IT IS THE RESPONSIBILITY OF THE CONTRACTOR TO MAINTAIN THE WORK AREAS WEATHER & WATERTIGHT AT THE END OF EACH WORK DAY DURING THE ENTIRE PROJECT. THE CONTRACTOR SHALL BE HELD LIABLE FOR ANY AND ALL WATER DAMAGES CAUSED BY HIS NEGLIGENCE.
- UNLESS OTHERWISE NOTED, ALL REMOVALS ARE TO BE PROPERLY DISPOSED OF.
- VERIFY ALL REMOVALS DO NOT AFFECT THE OPERATION OF EXISTING MECHANICAL, ELECTRICAL OR PLUMBING EQUIPMENT ON OR UNDER THE ROOF.
- IN THE EVENT THAT EXISTING UNFORESEEN ASBESTOS OR ASBESTOS RELATED ITEMS ARE ENCOUNTERED DURING CONSTRUCTION, THE CONTRACTOR SHALL IMMEDIATELY NOTIFY THE OWNER AND HALT THE WORK.

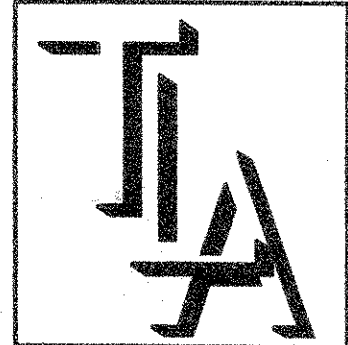

THOMAS LONARDO  
& ASSOCIATES  
A CORPORATION

- ARCHITECTURE •
- INTERIOR DESIGN •
- MANAGEMENT •

80 ATWOOD AVENUE  
CRANSTON, RHODE ISLAND  
(401) 944-2600 02920

PROJECT  
WARWICK  
SCHOOLS  
RE-ROOFING  
PROJECTS

ALDRICH  
MIDDLE  
SCHOOL

789 POST ROAD  
WARWICK,  
RHODE ISLAND

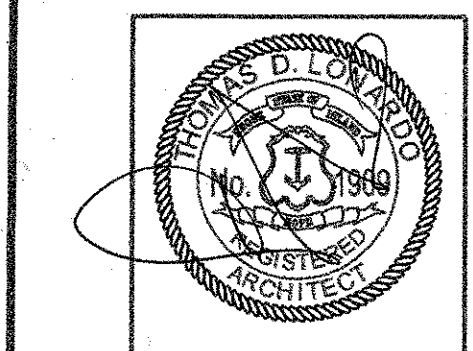

REVISIONS DATE BY:

THESE DRAWINGS ARE THE SOLE PROPERTY OF THE ARCHITECT. NO PORTION OF THIS DRAWING MAY BE REPRODUCED WITHOUT THE WRITTEN CONSENT OF THE ARCHITECT. THE PROJECT FOR WHICH THESE DRAWINGS HAVE BEEN PREPARED AND ARE NOT TO BE DUPLICATED OR COPIED IN ANY WAY. VIOLATION OF THIS COPYRIGHT AGREEMENT MAY LEAD TO LEGAL ACTION AGAINST THE VIOLATOR.

DRAWING  
ROOF PLAN  
& NOTES

SCALE: 1/16" = 1'-0"  
DRAWN: BASH  
CHKD. TDI  
P.I.C.  
DATE:  
PRP:

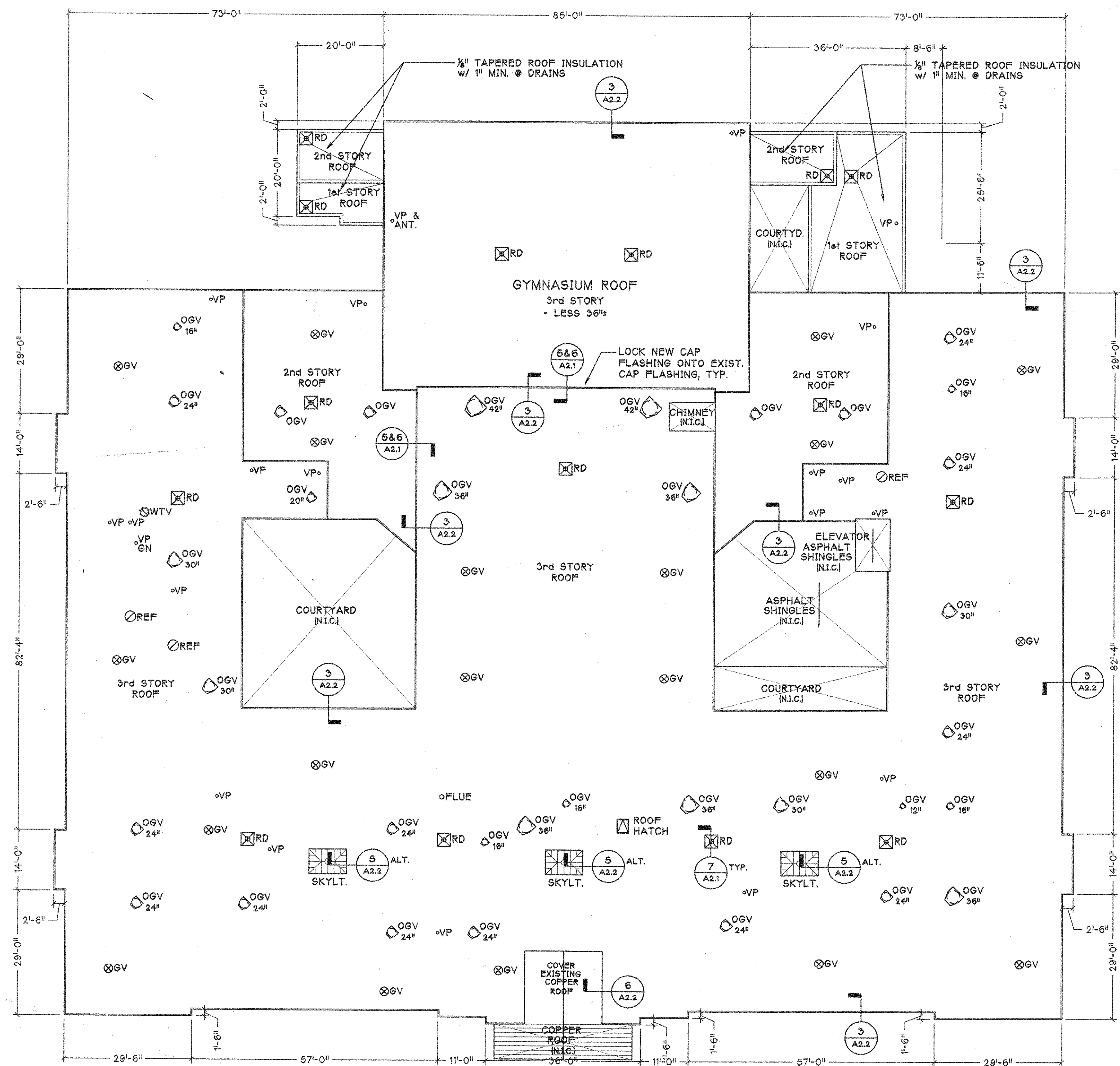

**ABBREVIATIONS:**

- ANT. ANTENNA
- CONC. CONCRETE
- GV GRAVITY VENT
- OGV OSCILLATING GRAVITY VENT
- N.I.C. NOT IN CONTRACT
- P.T. PRESSURE TREATED
- RD ROOF DRAIN
- REF ROOF EXHAUST FAN
- SKYL.T. SKYLIGHT
- VP VENT PIPE
- WTV WIND TURBINE VENT

1 ROOF PLAN  
A1.3 SCALE: 1/16" = 1'-0" ALDRICH MIDDLE SCHOOL  
40,000 +/- SQ. FT.

**GENERAL NOTES:**

1. SCRAPE & REMOVE EXISTING GRAVEL FROM ROOF; ROOF FELTS, EDGE METAL, EDGE BLOCKING AND INSULATION TO REMAIN. EXISTING ROOF SYSTEM IS TAR & GRAVEL BUILT-UP ROOFING ON INSULATION OVER CONCRETE SLABS & WOOD DECK AT THE GYMNASIUM ROOF.
2. USE APPROVED INDEPENDENT INSPECTOR TO VERIFY THE INTEGRITY OF EXISTING ROOF SYSTEM PRIOR TO RE-ROOFING. PATCH AND REPAIR DAMAGED EDGE METAL, EDGE BLOCKING AND INSULATION WHERE REQUIRED WITH SIMILAR MATERIALS. REVIEW AREAS OF DAMAGE WITH ARCHITECT PRIOR TO PROCEEDING WITH REPAIRS. COST OF REQUIRED REPAIRS TO BE PROCESSED AS CHANGE ORDERS BASED ON UNIT PRICES.
3. INSTALL NEW DOUBLE P.T. WOOD BLOCKING AS DETAILED AT PERIMETER OF ROOF, INSULATION, MEMBRANE, EDGE METAL & FLASHING AS SPECIFIED. THE NEW ROOF DRAINS TO EXISTING LEADERS OR DRAIN LINES AS DETAILED. COMPLETE INSTALLATION OF ALL RELATED FLASHING, LIFT AND RESET MECHANICAL EQUIPMENT AS REQUIRED TO INSTALL FLASHING AND TO MAINTAIN A MIN. 8 INCHES VERTICAL DIMENSION BETWEEN ROOF SURFACE AND TOP OF BASE FLASHING.

4. ALL EXPOSED EDGE METAL, COPINGS & FLASHING TO BE FACTORY FABRICATED, FASTENED IN ACCORDANCE W/ SMACNA & MANUFACTURER'S RECOMMENDATIONS. FIELD FABRICATED EDGE METAL & COPINGS WILL NOT BE ACCEPTED. ALL EXPOSED EDGE METAL, COPINGS AND FLASHING TO HAVE KYNAR 500 FINISH. COLOR TO BE SELECTED.
5. INSTALL COMPLETE SYSTEM AS REQUIRED TO PROVIDE ROOFING MANUFACTURER'S 15 YEAR WARRANTY. SYSTEM TO INCLUDE 60 MIL. NON-REINFORCED E.D.P.M. MEMBRANE, FULLY ADHERED TO 2" ISO. INSULATION WITH MIN. DENSITY OF 25 PSI, ANCHORED WITH MIN. PULLOUT\* OF 800 PSI TO CONCRETE DECK WITH 14-10 FASTENERS AND 3/8" PILOT HOLE & 1 1/2" MIN. PENETRATION. \* 360 PSI W/ WOOD DECK WITH HP FASTENERS.
6. RESURFACING OF ROOF TO INCLUDE THE ENTIRE ORIGINAL BUILDING.
7. REFER TO TYPICAL DETAILS ON SHEETS A2.1 & A2.2 FOR DETAILING OF ROOF PENETRATIONS (I.E., PENETRATION POCKETS, ROOF VENTS, PLUMBING VENTS, CURBS, ETC.)
8. ALL DRAINS ARE TO BE AUGURED OUT AFTER ROOF STRIPPING AND/OR ABATEMENT IS COMPLETE, AND ARE TO BE WATER TESTED TO INSURE DRAINAGE AFTER ROOF INSTALLATION.

**GENERAL REMOVAL NOTES:**

1. IT IS THE RESPONSIBILITY OF THE CONTRACTOR TO VERIFY ALL EXISTING CONDITIONS AND DIMENSIONS AS THEY RELATE TO THE RE-ROOFING (ALL DIMENSIONS GIVEN, ARE APPROXIMATE). REPORT ALL OBSERVATIONS AND ANY DISCREPANCIES TO THE ARCHITECT PRIOR TO PROCEEDING WITH THE WORK.
2. NO AREA OF REMOVAL IS TO BE LEFT OPEN OVER NIGHT OR DURING ADVERSE WEATHER CONDITIONS. IT IS THE RESPONSIBILITY OF THE CONTRACTOR TO MAINTAIN THE WORK AREAS WEATHER & WATERTIGHT AT THE END OF EACH WORK DAY DURING THE ENTIRE PROJECT. THE CONTRACTOR SHALL BE HELD LIABLE FOR ANY AND ALL WATER DAMAGES CAUSED BY HIS NEGLIGENCE.
3. UNLESS OTHERWISE NOTED, ALL REMOVALS ARE TO BE PROPERLY DISPOSED OF.
4. VERIFY ALL REMOVALS DO NOT AFFECT THE OPERATION OF EXISTING MECHANICAL, ELECTRICAL OR PLUMBING EQUIPMENT ON OR UNDER THE ROOF.
5. IN THE EVENT THAT EXISTING UNFORESEEN ASBESTOS OR ASBESTOS RELATED ITEMS ARE ENCOUNTERED DURING CONSTRUCTION, THE CONTRACTOR SHALL IMMEDIATELY NOTIFY THE OWNER AND HALT THE WORK.