

MATERIALS LIST									
FINISH DESIGNATION	TYPE DESCRIPTION	MANUFACTURER	STYLE	COLOR	SIZE	FINISH	LOCATION	NOTES	
RESILIENT BASE/ACCESSORIES									
B-1	RUBBER BASE	ROPPE	PINNACLE RUBBER BASE	TO MATCH EXISTING	5"	MANUF.	THROUGHOUT	COVE	
RESILIENT FLOORING									
RES-1	RESILIENT FLOORING	FORBO FLOORING	FLOTEX METRO	PEBBLE	20" x 20"	MANUF.	CHILDREN'S ROOM FIELD 1	TRANSITIONS INTO RES-2	
RES-2	RESILIENT FLOORING	FORBO FLOORING	FLOTEX METRO	SAND	20" x 20"	MANUF.	CHILDREN'S ROOM FIELD 2	TRANSITIONS INTO RES-1	
RES-3	RESILIENT FLOORING	FORBO FLOORING	FLOTEX PENANG	SAPPHIRE	20" x 20"	MANUF.	CHILDREN'S ROOM WATER		
RES-4	RESILIENT FLOORING	FORBO FLOORING	FLOTEX PENANG	NEPTUNE	20" x 20"	MANUF.	CHILDREN'S ROOM WATER		
RES-5	RESILIENT FLOORING	FORBO FLOORING	FLOTEX PENANG	AZURE	20" x 20"	MANUF.	CHILDREN'S ROOM WATER		
RES-6	RESILIENT FLOORING	FORBO FLOORING	FLOTEX METRO	EVERGREEN	20" x 20"	MANUF.	CHILDREN'S ROOM TREE		
RES-7	RESILIENT FLOORING	FORBO FLOORING	FLOTEX METRO	APPLE	20" x 20"	MANUF.	CHILDREN'S ROOM TREE		
RES-8	RESILIENT FLOORING	FORBO FLOORING	FLOTEX PENANG	EVERGREEN	20" x 20"	MANUF.	CHILDREN'S ROOM TREE		
RES-9	RESILIENT FLOORING	FORBO FLOORING	FLOTEX CALGARY	CEMENT	20" x 20"	MANUF.	CHILDREN'S ROOM STONES		
RES-10	RESILIENT FLOORING	FORBO FLOORING	FLOTEX CALGARY	GREY	20" x 20"	MANUF.	CHILDREN'S ROOM STONES		
CARPET TILE									
CPT-1	CARPET TILE	MATS INC	SUPREME NOP	CHARCOAL	24" x 24"	MANUF.	ELEVATOR FLOOR		
PAINT									
PNT-1	INTERIOR PAINT - TO MATCH EXISTING	BENJAMIN MOORE	N.A.	TO MATCH EXISTING	N.A.	TO MATCH EXISTING	AS NEEDED	TOUCH UP PAINT AS NEEDED	

FINISH LEGEND:

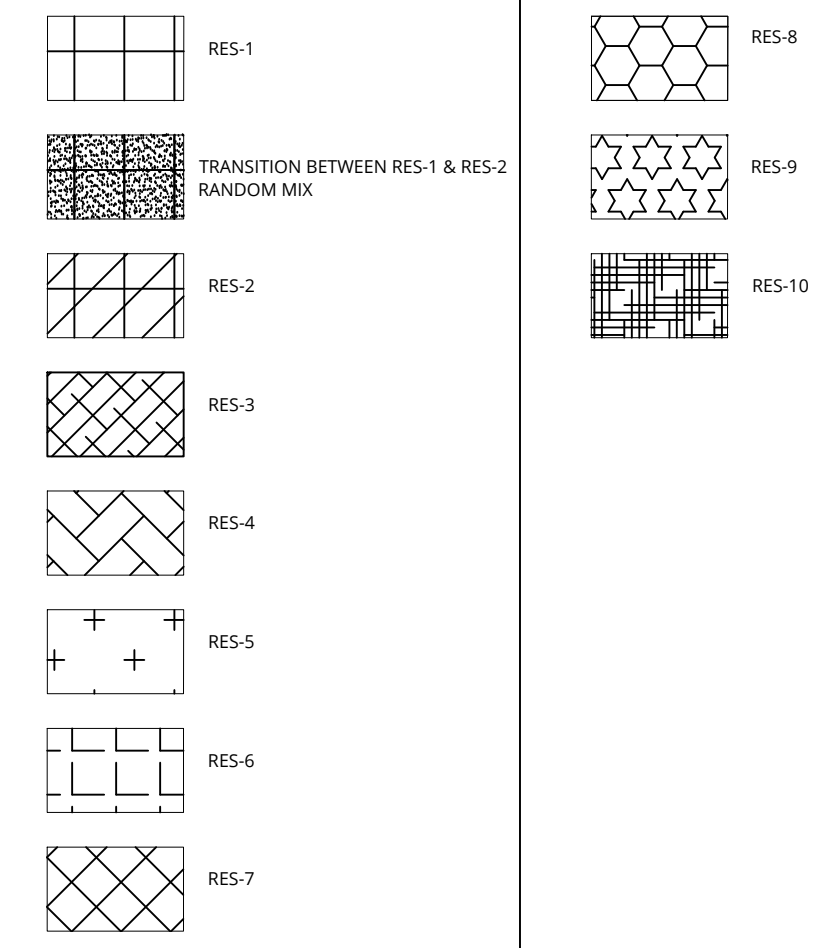

FINISH NOTES:

- TRANSITIONS BETWEEN ADJACENT FLOORING MATERIALS SHALL OCCUR UNDER THE CENTERLINE OF A DOOR (WHEN CLOSED), OR AS NOTED BY ARCHITECT. CONTRACTOR TO CONFIRM LOCATIONS OF FLOORING TRANSITIONS, AND LOCATIONS WITH ARCHITECT AND OWNER BEFORE BEGINNING WORK.
- CARPET INSTALLATION TYPE TO BE APPROVED BY ARCHITECT.
- ALL EXISTING TO REMAIN FLOORING TO BE PROTECTED DURING WORK. FLOORING NOT DIAGRAMMED WITH PATTERN SHALL BE ASSUMED TO BE EXISTING TO REMAIN.
- ELEVATOR CAB FLOOR INCLUDED IN WORK, VIF DIMENSIONS.
- PROGRAM ROOM WORK- ALTERNATE #1

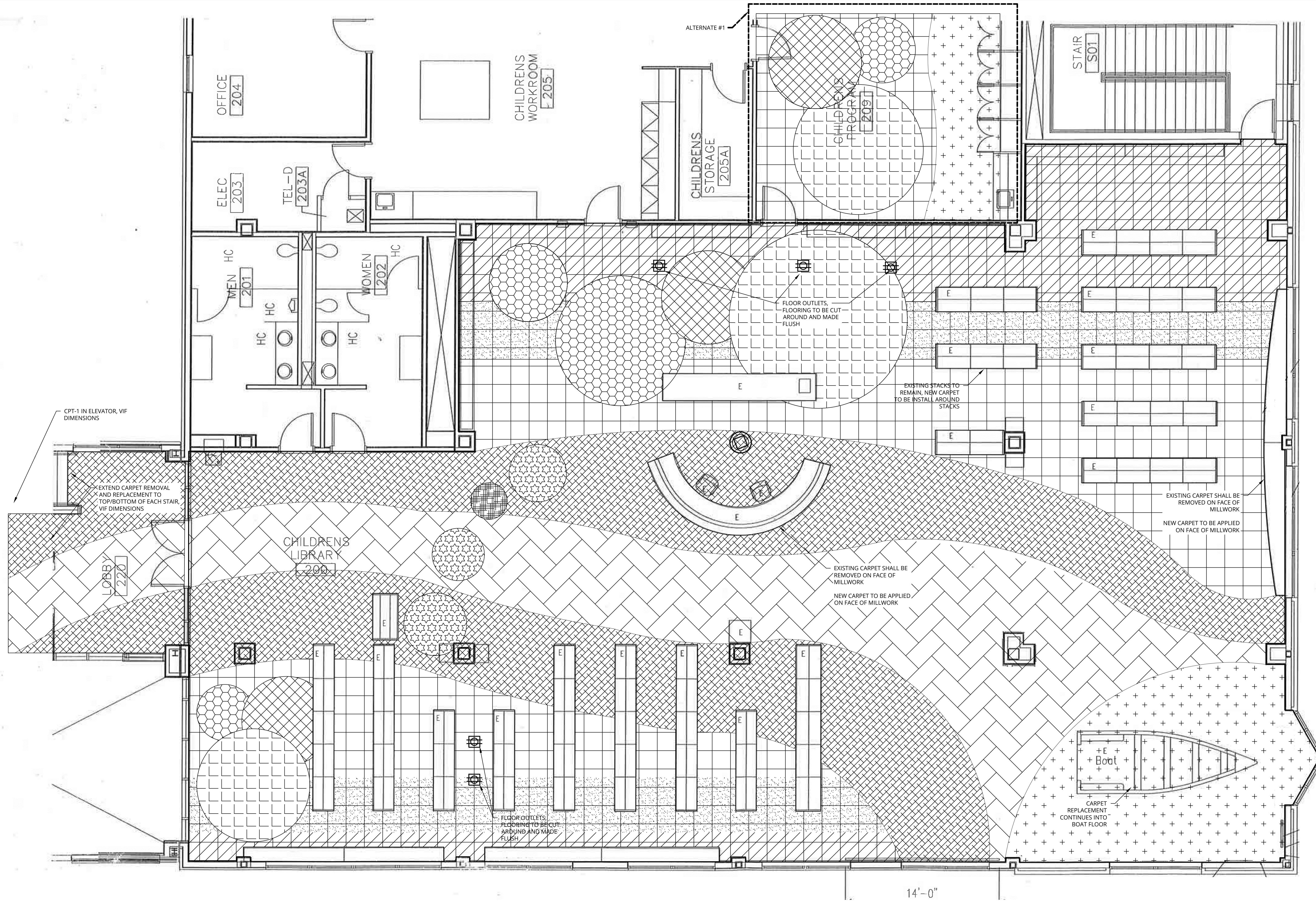

Carpet Replacement to Warwick Public Library, Central Library
Children's Room
600 Sandy Lane
Warwick, RI 02889

Issued for Bid
NOT FOR CONSTRUCTION
12/27/17
Revisions

Proposed Finish Plan and Materials List